



Single rotary-flange type has a mounting flange at the bottom to be lower in height.

4 types are available from 2 to 8 circuits. Each circuit can be set up independently.

When supplying fluid from flange side, apply manifold piping.

Single rotary type : Flange type

Rotary shaft is polished, chrome-plated and super-finished for maximum seal performance and durability.

Major parts are ion-nitrided for wear-out and corrosion resistance.

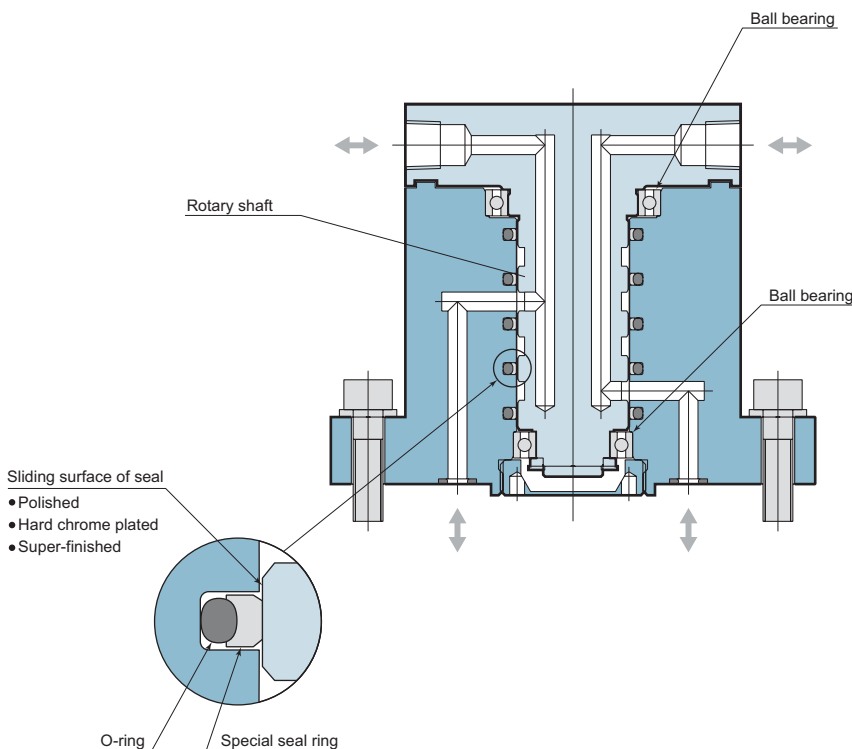

※ Mounting screws are not included.

2-Circuit type model WRA2F

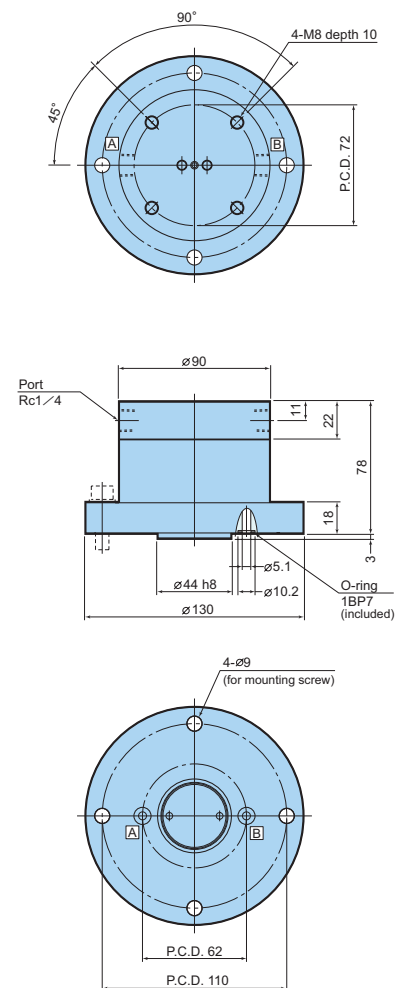

※ "A","B" are marked at each port.
The mounting surface finish should be no rougher than Rz6.3 (ISO 4287:1997)

model	WRA2F	WRA4F	WRA6F	WRA8F
Number of circuit	2-Circuit	4-Circuit	6-Circuit	8-Circuit
Fluid used	Mineral oil or Air			
Maximum working pressure	25 MPa			
Maximum revolving speed	Varies according to the pressure applied (refer to the diagram on the back page)			
Ambient temperature	0 ~ 70° C			
Port size	Rc 1/4 (Manifold piping for bottom surface of body)			
Mass	4.9kg	6.1kg	10.9kg	14.9 kg

4-Circuit type model **WRA4F**

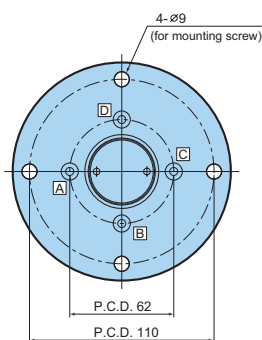
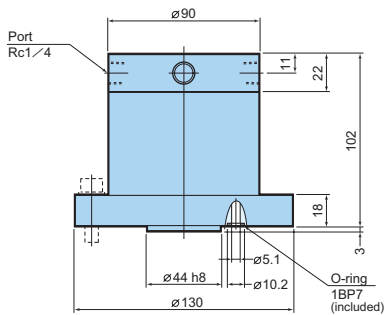
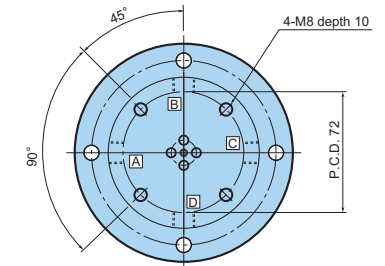

※ "A"~"D" are marked at each port.
The mounting surface finish should be no rougher than Rz6.3 (ISO 4287:1997)

6-Circuit type model **WRA6F**

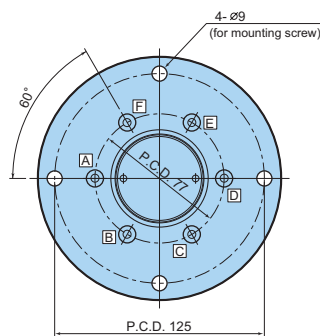
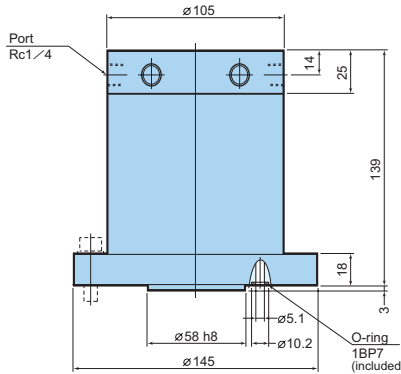
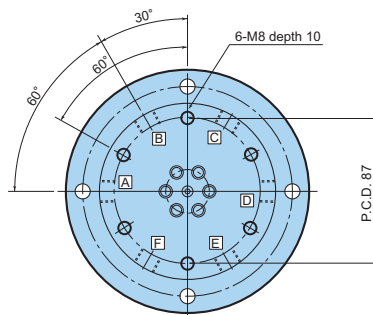

※ "A"~"F" are marked at each port.
The mounting surface finish should be no rougher than Rz6.3 (ISO 4287:1997)

8-Circuit type model **WRA8F**

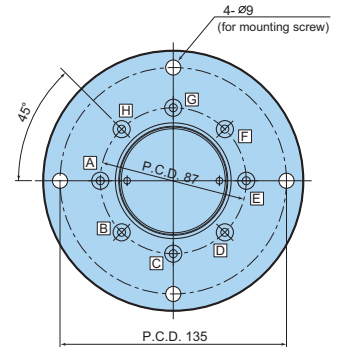
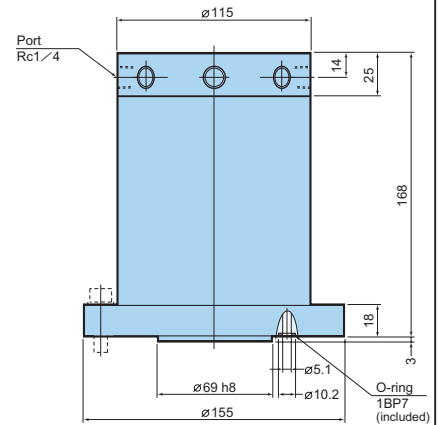
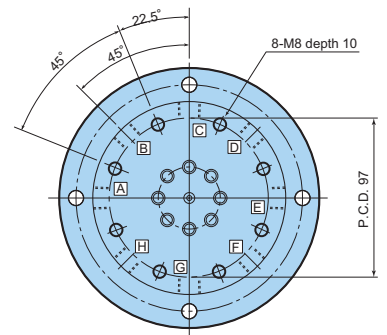

※ "A"~"H" are marked at each port.
The mounting surface finish should be no rougher than Rz6.3 (ISO 4287:1997)